

Emergency Assistance/ Toilet Alarm Controller

Compliant to BS8300-2:2018



The 4-way toilet alarm control panel (the DTA4) is the latest addition to our DTAKIT range of products.

Simply connect the new panel to up to four assistance/toilet alarm kits for an easy to operate alarm system.

A stylish product with a full range of functions, including fault monitoring.

Watch a video
review of the [DTA4 & DTAKIT](#).

CONTROL PANEL:

- Simply connect to up to four emergency assistance/toilet alarm kits (see right) for a fully compliant - and monitored - assistance alarm system.
- Panels can be daisy-chained to add more alarm kits from one mains connection.
- The controller features both visual and audible indications of an incoming call.
- Each alarm point is clearly indicated on the panel, with space for the user to add individual zone labelling.
- The panel has four 'call acknowledge' buttons and incoming call LEDs - one for each alarm point connected.
- When the relevant 'call acknowledge' button is pressed on the panel, the caller will notice audible and visual changes to the alarm indicators, thus providing reassurance that help is on the way.
- In addition, the system has a programmable alarm 're-sound' feature. This will operate if a call has been acknowledged at the control unit, but is not reset at the point of call within the specified time.
- A separate relay output enables connection to an external beacon - allowing the opportunity to add a remote indicator to alert staff in a different area.
- The unit has a built-in mains power supply and an LED to confirm that the system is powered and available for use.
- The system is monitored and will indicate a short or open circuit condition. The display will also show which alarm point is at fault.

- As with all our toilet alarm products, the control unit is available with a white or stainless steel finish.
- For ease of installation, the panel fits into a standard double gang back box (not supplied).
- Compatible with all DTAKIT assistance call options, including the IP65 rated products.

DTAKIT PRODUCTS & CODES:

4-way Controller	White	Stainless Steel
Control panel	DTA4	DTA4S
Toilet Alarm Kit	White	Stainless Steel
3 part kit	DTAKIT	DTASKIT
Ceiling pull	DTACP	DTASCP
Over-door light	DTAODL	DTASODL
Reset point	DTARP	DTASRP
WC door sign label	DTALAB	
Assistance Call	White	Stainless Steel
Call button	DTACB	DTASCB
Call button + reset button	DTACBRP	DTASCBRP
Wall mount pull cord	DTACPW	DTASCPW
Call button + 6.35mm jack	DTACBJ	DTASCBJ
IP65 Rated		
Pull cord	DTACPM	
Call button	DTACBM	
Reset button	DTARPM	
Call & reset point	DTACBRPM	

KEY FEATURES:

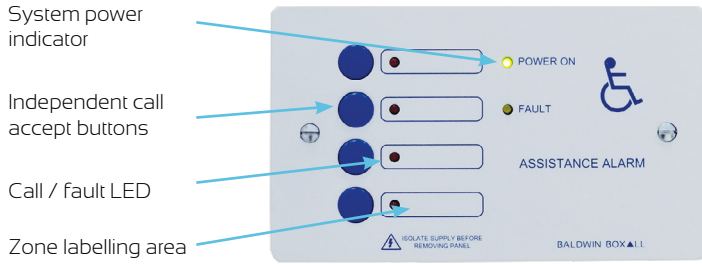

- » Monitored system with fault LED to indicate if a 'short' or 'open' circuit condition is detected.
- » 'Call acknowledge' feature reassures the caller that help is on the way (both audible & visual alarms change at point of call when acknowledge button is pressed).
- » Only a single mains connection is required - direct to the panel - no additional power source is needed.
- » Fully BS58300-2:2018 compliant

Dimensions: 146 mm (W) x 3 mm (D) 86 mm (H).
 (Requires a 35 mm double gang back box).
 Weight: 0.32 kg.
 White RAL 9016 / stainless steel grade 304

CABLING & CONNECTIONS:

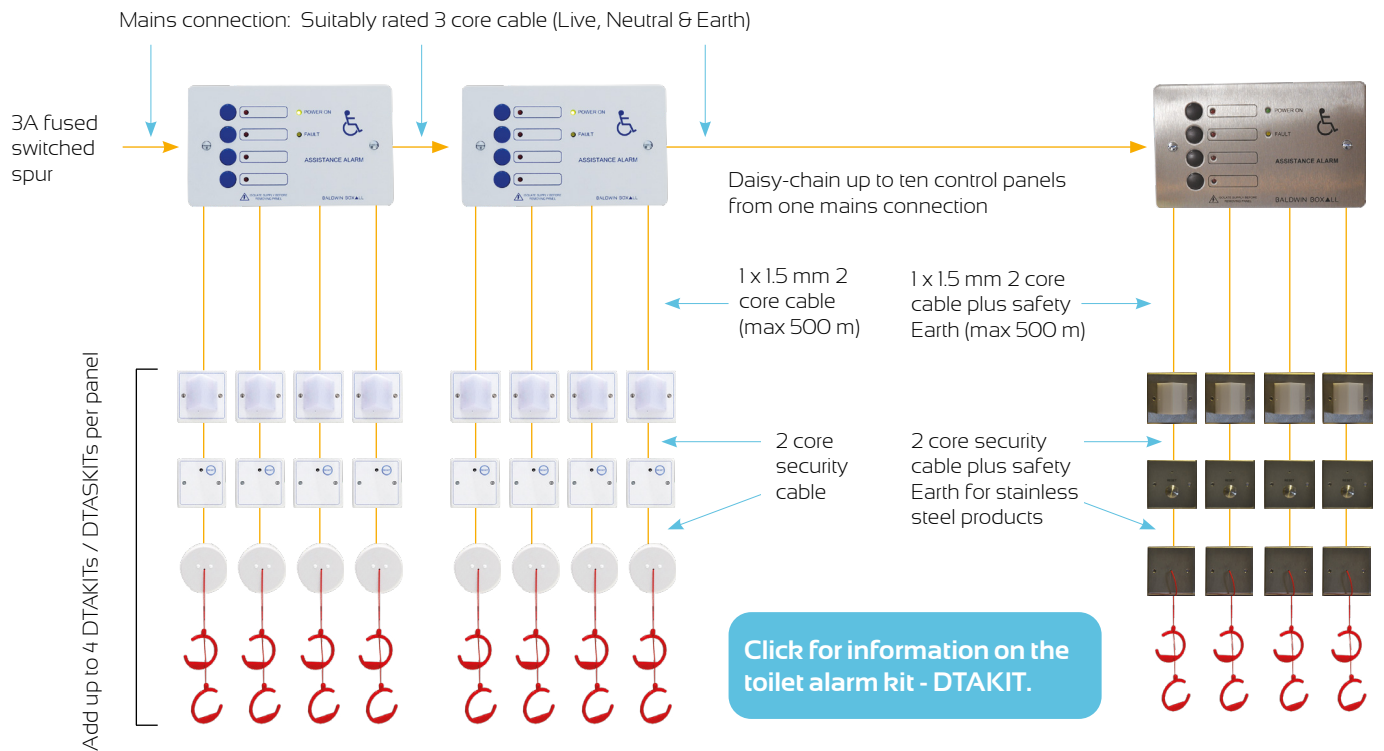

[Download Cabling Information](#)



BALDWIN BOXALL
 LEADING THE WAY TO SAFETY

Baldwin Boxall Communications Ltd
 Wealden Industrial Estate, Farningham Road,
 Crowborough, East Sussex, TN6 2JR, United Kingdom
 T: +44 (0) 1892 664422
 E: hello@baldwinboxall.co.uk
 W: www.baldwinboxall.co.uk